

**FLANGED BUSHES****Type FBF/FBFN**

Versatile bushes that provide the ability to extend service life of suspension components in vehicular applications.

The FBF and FBFN series bushes are designed and constructed using different materials, and are shaped to provide a maintenance free function by outlasting the predicted life of leaf spring and suspension in automotive applications.

**STANDARD PRODUCTION**

Fe 360 Steel (ISO 3305/3306)

Natural rubber NR

Zinc plated in accordance with CE standards CHROME VI free, white

Stiffness tolerance +/- 20%

**APPLICATIONS**

- Flexible Joints • Motor vehicles
- Earth moving machinery • General machinery & equipment

OPTIONS & ADDITIONAL PARTS

Alternative elastomeric hardness and compounds available

FLANGED BUSHES

Type FBF/FBFN

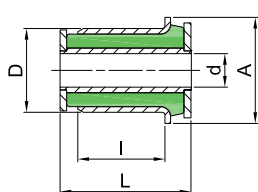

Type 1

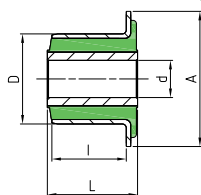

Type 2

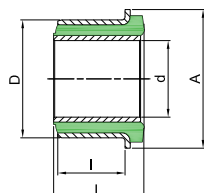

Type 3

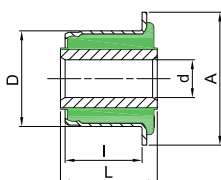

Type 4

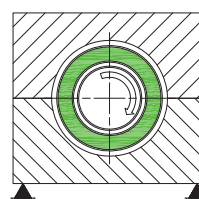
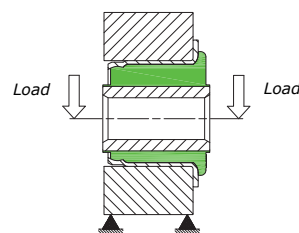

INSIDE DIAMETER (d) TOLERANCES

from	8 mm	to 15mm	-0 / +0,15
from	16 mm	to 25mm	-0 / +0,30
from	26 mm	to 50mm	-0 / +0,40
over	51 mm	to be defined	

OUTSIDE DIAMETER (D) TOLERANCES

from	16 mm	to 30 mm	-0 / +0,10
from	31 mm	to 70mm	-0 / +0,15
from	71 mm	to 100 mm	-0 / +0,20
over	101 mm	to be defined	

Approximate schemes for forces and constraints

N.B. The Driving Seat must assure a minimum interference of 0.02mm, with a tolerance of -0.05mm

i.e. A Bush with an Outside Diameter of 30mm must be fitted into a hole with a dimension of 30mm -0.02/-0.05mm (i.e. 29.98 - 29.93mm)

Subject to agreement, we are able to supply products to closer tolerances where required.

*** STANDARD HARDNESS 55 IRHD • STANDARD HARDNESS 65 IRHD # STANDARD HARDNESS 80 IRHD**

(N.B. 1 daN = 1.0197 kgf)

Item	d	D	l	L	RADIAL		TORSIONAL		Type
					Stiffness (daN/mm)	Deflec.max (mm)	Stiffness (Nm/°)	Angle.max (+/-°gradi)	
• FBF1230.2645	12	30	26	45,5	357	0,8	1,2	30	1
• FBF1230.3147	12	30	31	47	462	0,8	1,4	30	1
* FBF1640.2835	16,5	40	28	35	289	0,9	1,9	30	2
# FBF1640.2843	16,5	40	28	43	790	0,9	5,2	30	2
• FBF1640.3340	16,5	40	33	40	621	0,9	3,6	30	2
• FBF1646.3240	16	45,7	32	39,9	283	1,3	3,2	20	2
• FBF2952.2332	29	52	22,5	32	1320	0,7	9,9	20	3
• FBF2952.3342	29	52	32,5	42	2455	0,7	13,8	20	3
• FBF3252.2332	32	52	22,5	42	1320	0,7	9,9	20	3
• FBF3252.3342	32	52	32,5	42	2455	0,7	13,8	20	3
• FBF3757.3242	37	57	32	42	2220	0,8	16,9	20	3
• FBFN1640.3341	16	40	33	41	621	0,9	3,6	30	4
• FBFN1640.3846	16	40	38	46	661	0,9	4,0	30	4

FIBET GROUP operates a policy of continuous improvement and development. We reserve the right to change design and specification of our products without prior notification or alteration of literature.